

---

SKY ROOF







They turned and saw the Lion himself, so bright and real and strong that everything else began at once to look pale and shadowy compared with him."

- C.S. Lewis

# SKYROOF

The epitome of strength, Skyroof rises from the ground, like a silent bodyguard. Angular, solid and dependant. Then at the touch of a button, transforming into the embodiment of delicacy, as rays of light filter softly through, and ribbons of golden sunlight spill into the room.





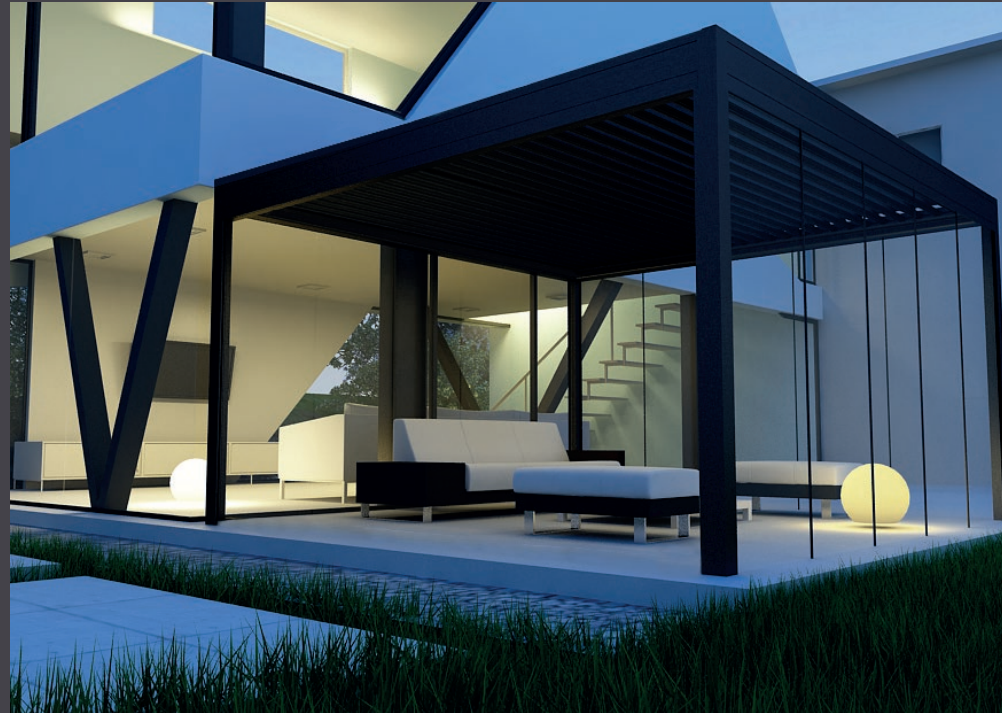

Skyroof is a practical module design meaning that the customer can slot together several units in different configurations in order to get the best out of their available space.



The panels are made from aluminium and fastened with stainless steel fixings, meaning that this secure structure can bear large amounts of snow or water without caving in. Powered by an electric motor and sealed with a high quality gasket plug, it provides a completely airtight space which can be used in all weather.















The solid aluminium profile which is streamline in appearance with integrated drainage and lighting systems is also extremely strong.



With its angular details Skyroof fits perfectly with modern architecture, but also sympathetically merges with any type of building, meaning that it can be used as both a private enclosure or at a hotel or restaurant.













*And if you have a minute why don't we go*

*Talk about it somewhere only we know?*

*This could be the end of everything*

*So why don't we go,*

*Somewhere only we know?*

*KEANE*







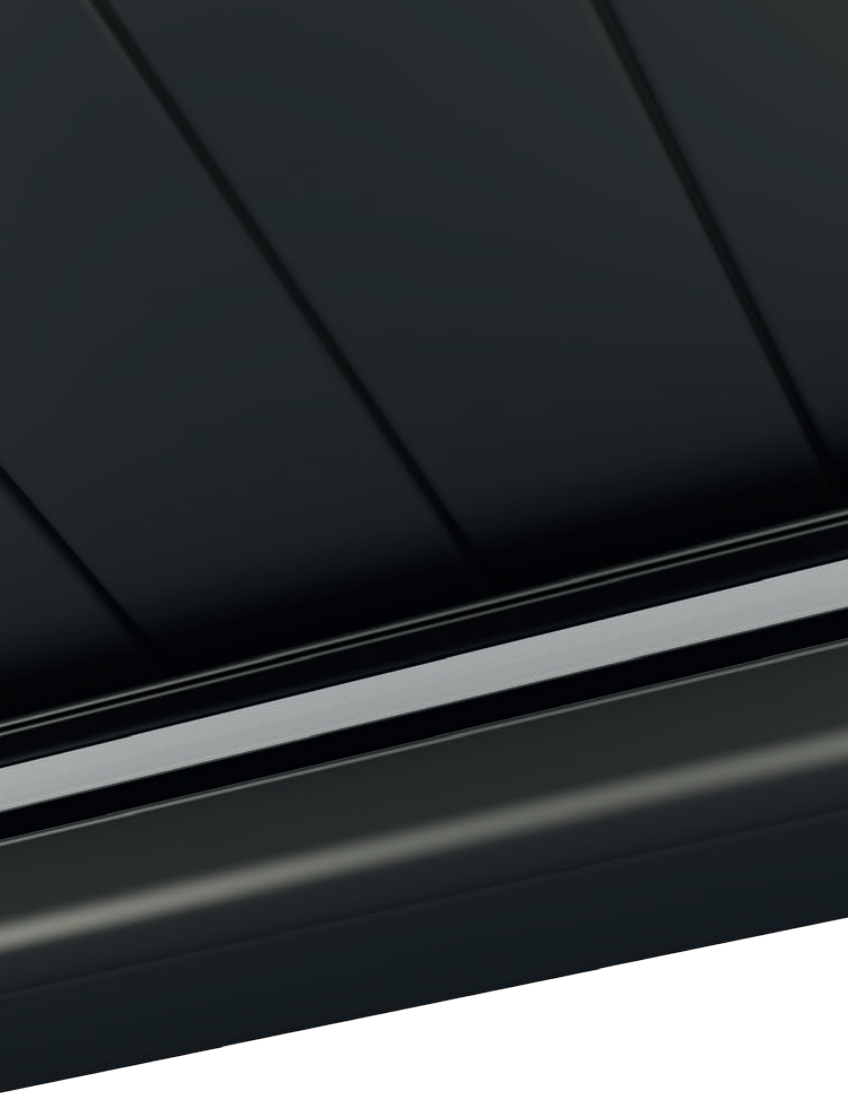

# Technical Details

---



## CONTROL & AUTOMATION

We are proud to present our own App which has been designed specifically for our products and is available at Apple's App store.

Now you can take full control of your Outdoor experience and choose from several options, directly from your iPhone or iPad.

These include:

- Operate the roof
- Dim the lights.
- Control the Awnings & Blinds



iPhone & iPad  
**Control**

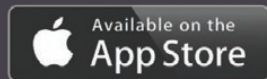



## LIGHTING

---

Depending on whether you want strong practical lighting, or an atmospheric dimmed ambience, you can choose our optional Linear Lights.

The lights of the product are integrated in to the overhead panels and can be dimmed to create the perfect ambience. These and the operation of the panels simply controlled by the touch of a button.

Investing in LED technologies is a part of our contribution to a greener environment.





# ROOF PANELS

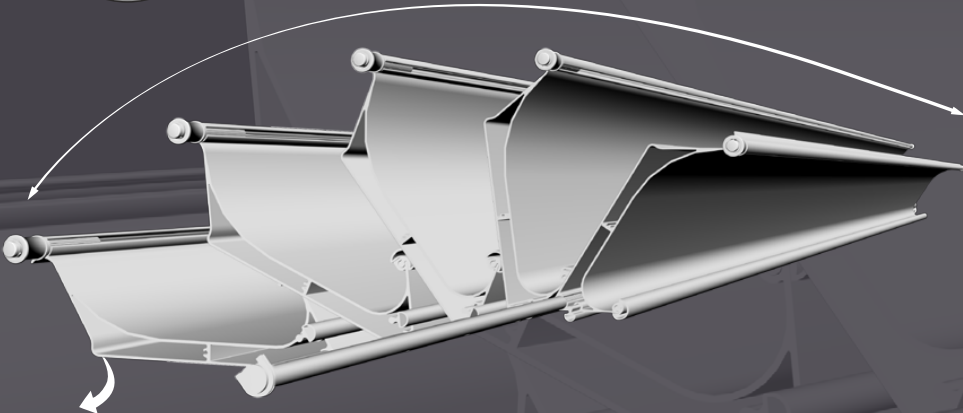

## AIR TUNNEL

The motorized roof panels are rotatable to 120 degrees, enabling the customer to position them exactly where desired in order to block or to catch the rays of sun.

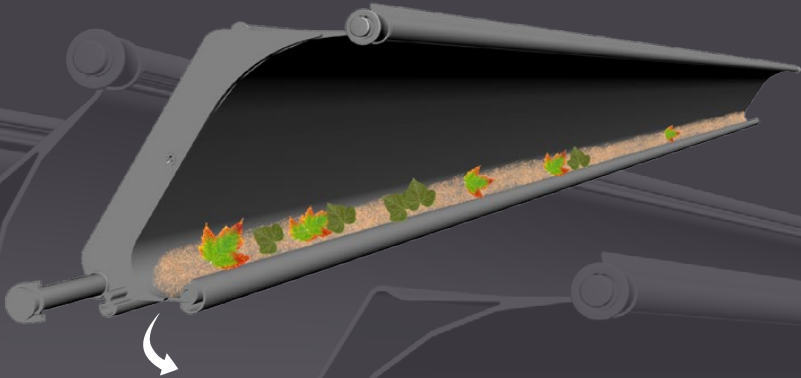

## INTEGRATED PANEL GUTTER

When the roof panels are closed it is inevitable that outdoor particles such as leaves and dust will gather then. The integrated panel gutter prevents this paraphernalia from falling into your indoor space on retraction.



## INSULATION

Insulated Panels filled with a PUR Foam add extra value to this Product, especially for products with glass enclosure. With this solutions the customer gets extra comfort during cold winter or hot summer days and the formation of condensation is significantly reduced.



## WATER DRAINAGE

The ingenious drainage system is fully integrated with in the entire system and effortlessly guides all the water off the product and out through the pillars despite the product being completely flat.

## MULTIPLE SEALING

Several perfectly positioned gaskets prevent all wind or water from entering the product meaning that it is completely water and airtight.



*Panel Gaskets*



*Central Gasket*

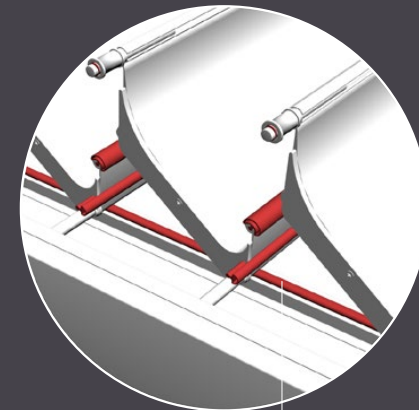

*Base Gasket*



# SECTIONS & DIMENSIONS

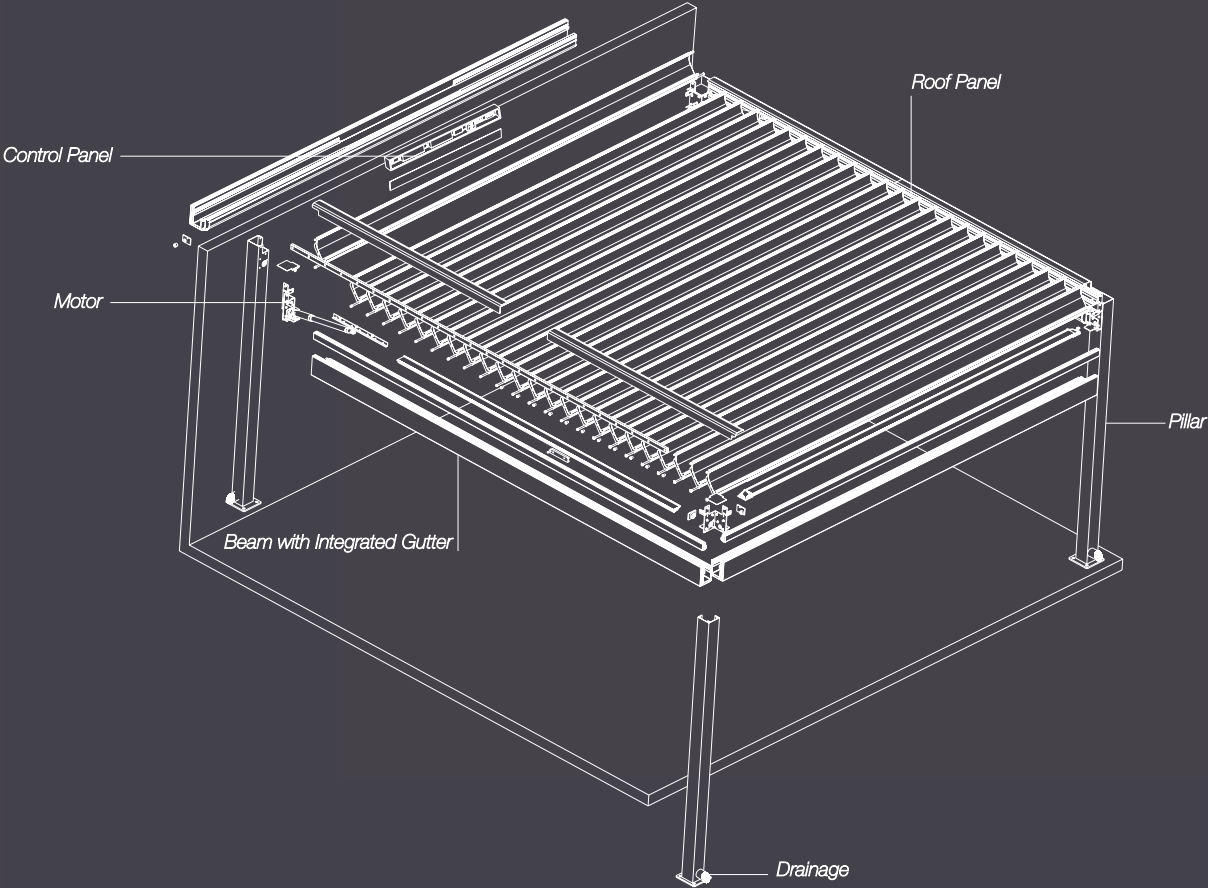

Max. Dimensions

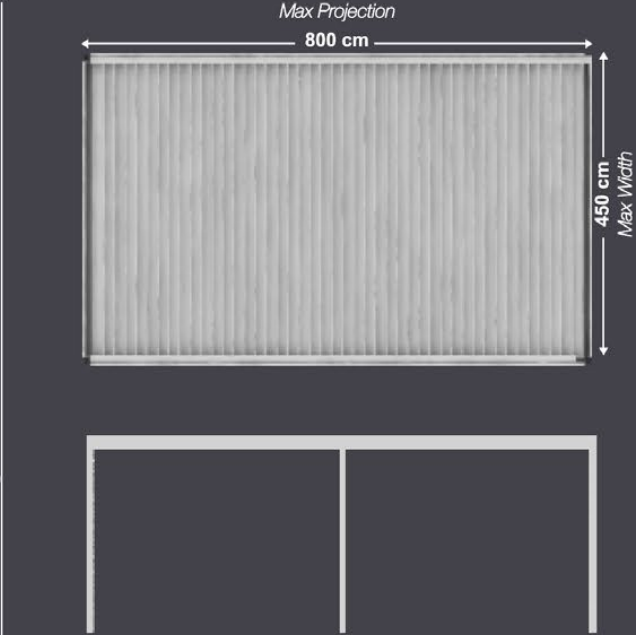

\*No Side Pillar needed for projections up to 588 cm.  
\*\* The Units can be free standing or wall mounted.



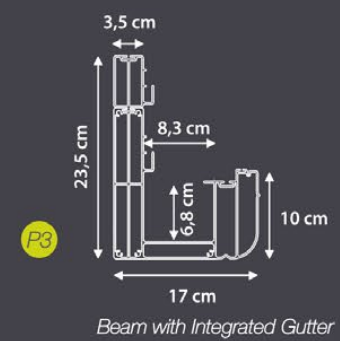
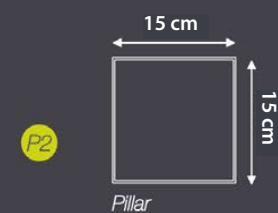
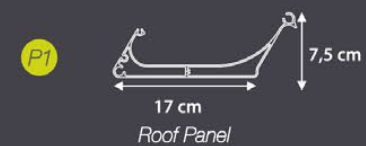
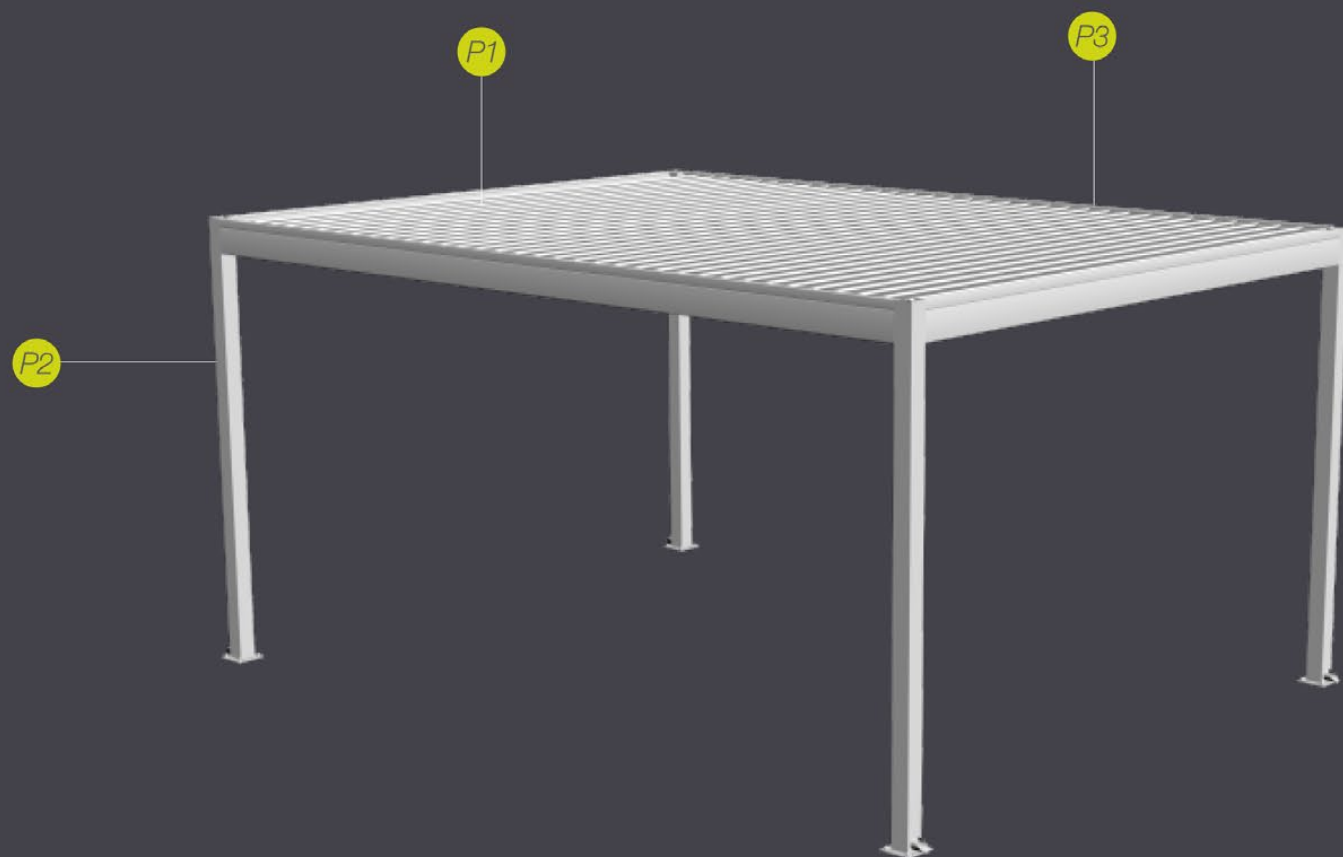

The values of each different culture and their unique architectural concepts, inspire and are reflected in our products.







#### 5-Years Warranty

All our products have up to 5 years guarantee.

**LOCA**  
[www.loca.eu](http://www.loca.eu)

**DIBA**  
[www.dibats.com](http://www.dibats.com)